

LTR	REVISION RECORD	ECN NO.	DRG	DATE
A	First Issue	RD13-0825001	King	8/25'13

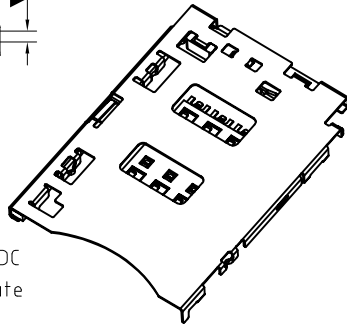

Circuit Diagram For Switch

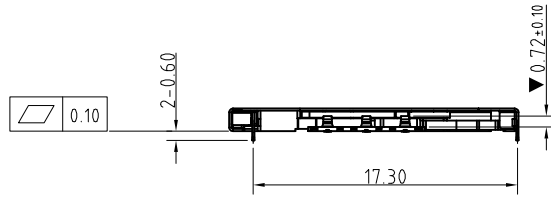
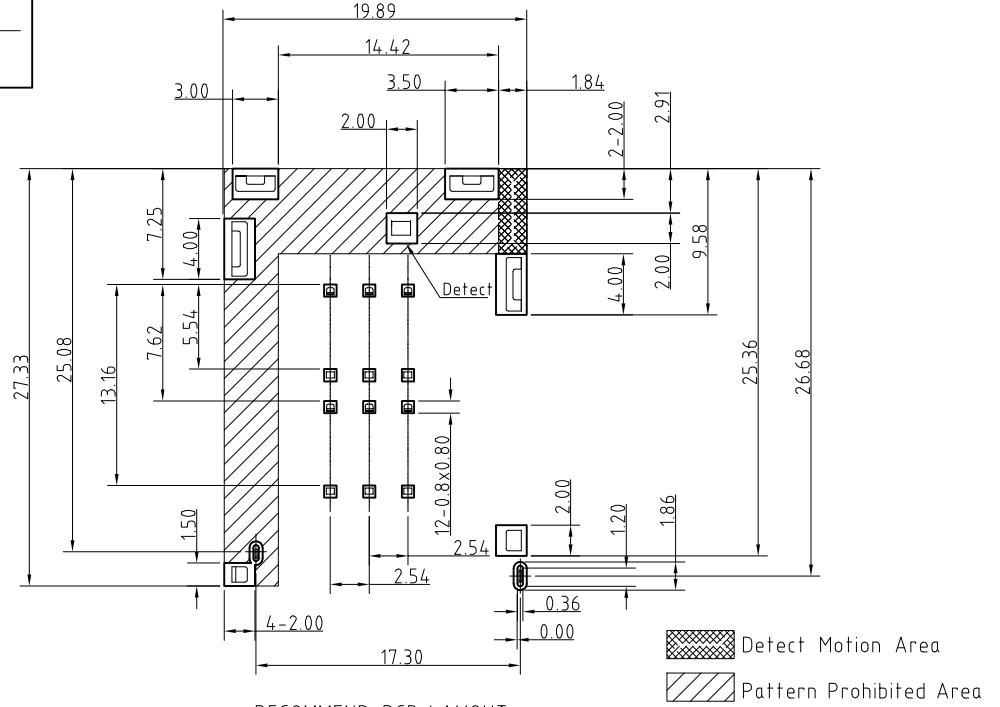
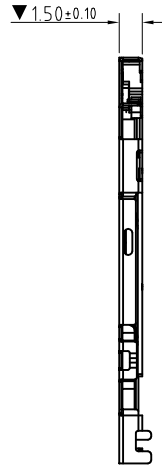
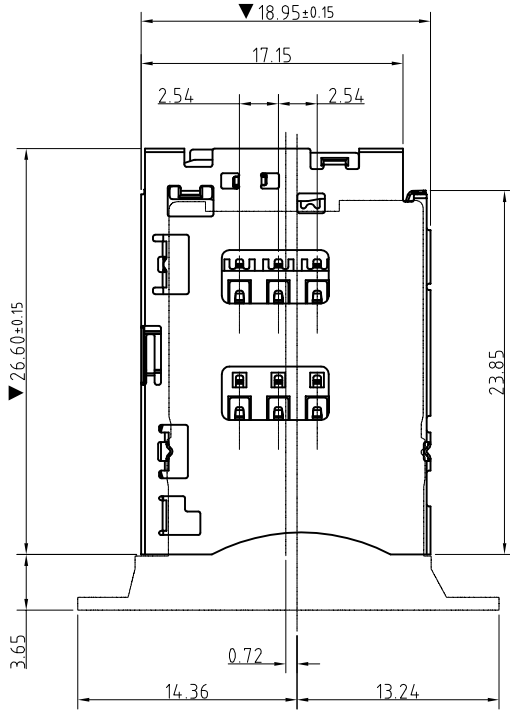
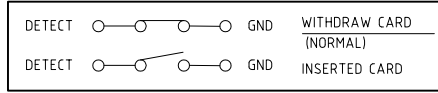

- NOTE:
- Specification:
    - 1-1.Current Rating :0.5mA max.
    - 1-2.Contact Resistance:100mOhms max
    - 1-3.Insulation Resistance:1000MOhmsΩ min./500VDC
    - 1-4.Dielectric Withstanding Voltage:500VAC/1minute
    - 1-5.Operating Temperature:-25°C to +85°C
    - 1-6.Mating Cycles:3,000 Insertions
  - Product Compliant to RoHs Directive 2002/95/EC and ELV 2000/53/EC
  - Please Contact PROMAX Sales Representative to Verify Product Details.

Shell	Stainless Steel	Ni Plated Over All, Contact Area ,Solder Tail Gold Flash.
Lever	Stainless Steel	No Plated
Cam	Stainless Steel	No Plated
Housing	Thermoplastic	Color Black UL 94V-0
Detect	Phosphor Bronze	Ni Plated Over All, Contact Area Gold Flash ,Solder Tail Plating Sn
Contacts	Phosphor Bronze	Ni Plated Over All, Contact Area ,Solder Tail Gold Flash.
Part Name	Material	Description

CUSTOMER INSPECTION DRAWING  
 深圳市普玛斯精密组件有限公司  
 SHENZHEN PROMAX EXACTITUDE DISCRETENESS CO.,LTD .

APPROVED:	Jean Long	GENERAL TOLERANCES	TITLE:	15H Lever Type Mini SIM CARD CONN.	
CHECKED:	Jean Long	.X:	±0.30	PART NO:	MC09-52150-7F
DRAWING:	King Hsu	.XX:	±0.20	DWG NO:	DMC09-52150
		.XXX:	±0.10	REV: A	UNIT: mm
		ANGEL:	±1°	SCALE: /	SHEET: A4
		SHEET:	1 / 1		